



Better Nutrition made simple.



SY26/27 RED GOLD FOODSERVICE DISPENSER AGREEMENT FORM FOR EDUCATION CHANNEL

Form with fields for DATE, COMPLETED BY, TITLE, ACCOUNT NAME, CONTACT, SHIPPING ADDRESS, CITY /STATE, ZIP, EMAIL, PHONE, REQUESTED ARRIVAL DATE, # OF CAFETERIAS/SITES, # OF DISPENSERS/SITE, DISTRIBUTOR(s) for Product, and Historical Condiment Data /Usage.

Table with columns: ITEM #, GTIN, RED GOLD BRAND PRODUCT DESCRIPTION, QUANTITY REQUESTED (RED GOLD, UNIVERSAL, TOTAL), and TWO YEAR CASE COMMITMENT (X 100 CS/ DISPENSER, TOTAL CS, Avg. Cases/ Year).

Red Gold to provide total number of Condiment Dispensers listed at the right at no charge. Customer identified below agrees to the following terms and conditions:

Table with 3 columns: Customer Initial, ID (1-7B), and terms/conditions for the dispenser agreement.



Please Note: Red Gold is not responsible for the replacement of parts or service of any dispensers once shipped. Please visit Amazon or BuyRedGoldNow.com to order additional dispensers, replacement parts or accessories.

Education Team Contact Information & Email for Return of Completed Form: Approval, Fulfillment, K12 Manager, Field Manager, Broker.

Signed this ___ day of ___ (month) 20___ (year). Signature, Title, and Account Name fields.



Red Gold SY2526 Education Dispenser Program Summary & Tips for Success

Red Gold is pleased to be able to offer Condiment Dispensers to our K12 customers under 2 scenarios.

1 Purchase the Dispensers directly from Red Gold at \$139.10/dispenser

- a See Red Gold Condiment Sheet to reference code numbers for ordering
- b Earn \$.50/case Rebate on all purchases of bulk condiment products - no limit (details / TBD)

2 Engage in a Purchase Commitment Program with Red Gold for a minimum purchase quantity per dispenser (100 cases /dispenser placed)

- a Purchase commitment can be spread over 2 years
- b Commodity Purchases are eligible on all items with Tomato Paste
- c Insure the Distributor will stock (or special order) the product prior to program commitment
- d Evaluate your current condiment purchases for estimated usage to determine how many dispensers you may qualify for under the terms of program
- e Consider terms of procurement to insure multiple year purchase commitments are allowed and will not interfere with the process.

3 Construct a Dispenser Program using a combination of both options, depending on usage requirements and dispenser needs.

- a Carefully consider the number of dispensers needed based on site and location. Some sites may need multiple dispensers based on condiment/ flavor stations, but volume may not warrant the number of dispensers being requested.

Key Learnings from Condiment Dispenser Experience with School Districts

- Try a TEST first and see how it works - this includes from both the student perspective as well as your managers; Red Gold will gladly support a Dispenser
- A Test, with limited product for one menu day, to insure this makes sense for you. It will also give you an opportunity to see how much product is utilized on a particular menu day.
- B Focus on Middle and High School Locations; Elementary School sites should be considered very carefully and tested.
- C Start small - you can always add more dispensers later.
- D Consider dispensers for high volume condiments only; low volume condiment usage may not justify placement under Option 2.
- E Watch the Red Gold Server Training Video prior to implementing a Program and consider local broker support for implementation.
- F Understand that Parts and Service are not a part of the program; Part replacement is handled directly by Server.
- G If you have any questions or concerns prior to getting started, please do not hesitate to contact a Red Gold K12 Team Member or your local broker.

Red Gold Education Team Sales Contacts:

Jodi Batten, SNS - National Sales & Marketing Director - Education / Government
Phone: 512-910-3265/ Email: jbatten@redgold.com

Indiana HQ / National Education & Government Team Support:
Josh Chaffin Phone: 765-557-5500 x1611 / Email: jchaffin@redgold.com

Local Broker Support:

Red Gold K12 Website Support:

<http://www.redgoldfoods.com>
www.k12tomatoes.com

Pouch Dispenser Unit

Model #9875



*Use with pouch up to 1 1/2 gallons.

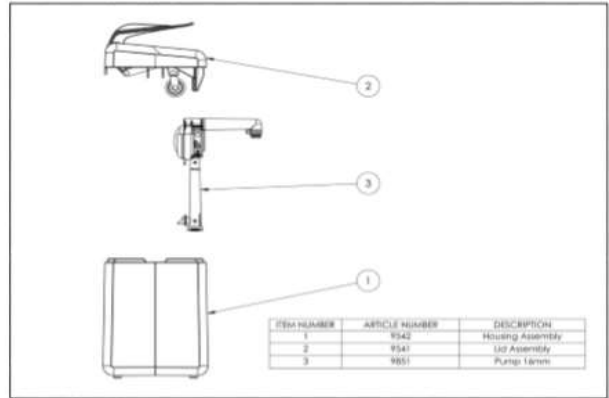

1. Disassemble and clean before use

We recommend to clean the pump before first time use. In order to do so, you have to disassemble the pump's parts, see the detailed instruction below. Wash the parts by hand or in a dishwasher, using ordinary dish soap.

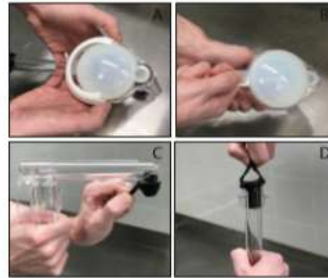

- A Remove the dome clip
- B Remove the dome
- C Remove the nozzle
- D Remove the check valve

2. Reassemble after cleaning



Mounting the check valve

Turn the outer part of the check valve inside out. Insert the check valve into the pump housing and flip the outer part of the check valve over the housing. Fasten the valve by hooking the two flaps onto the the taps of the pump housing.

Mounting the nozzle

Turn the outer part of the nozzle inside out. Insert the nozzle into the pump housing and flip the outer part of the nozzle over the housing. Make sure that the ear of the nozzle is pointed towards the dome.

Mounting the dome and clip

Mount the dome. Press the small tap (see the arrow) so that air cannot enter the dome. Mount the dome clip and ensure that the tap of the dome goes through the opening in the dome clip.

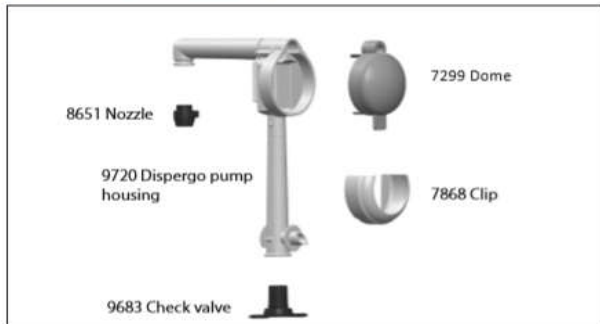

3. Connect the pump to the pouch

Put a new pouch on a flat surface. Locate the fitment. Place the connector of the pump in the centre of the fitment. Firmly push the connector into the fitment until it snaps in place.



4. Insert the pump and pouch

Hold the pump and the pouch with both hands. Let the pouch slide into the dispenser housing and guide the pump into the slots inside the dispenser housing.



5. Secure the pouch

Secure the pouch with the pouch clip.



6. Attach the lid

Lower the lid onto the dispenser housing while holding back the lever. When the lid is in line with the housing you are ready to pump.

Note

The portion size per pump stroke is factory set to 1 fl oz (15 ml). If another portion size is desired, please contact Red Gold for instructions.



Red Gold, Inc.
 P.O. Box 83 Elwood, Indiana 46036
 For Consumer Relations Only: (866) 729-7187
 Company: (765) 557-5500 Fax: (765) 557-5501
 Customer Service Hours M-F 8am-5pm EST